

allseitig bearbeitet/ completely machined/ usiné complètement

Code -8./

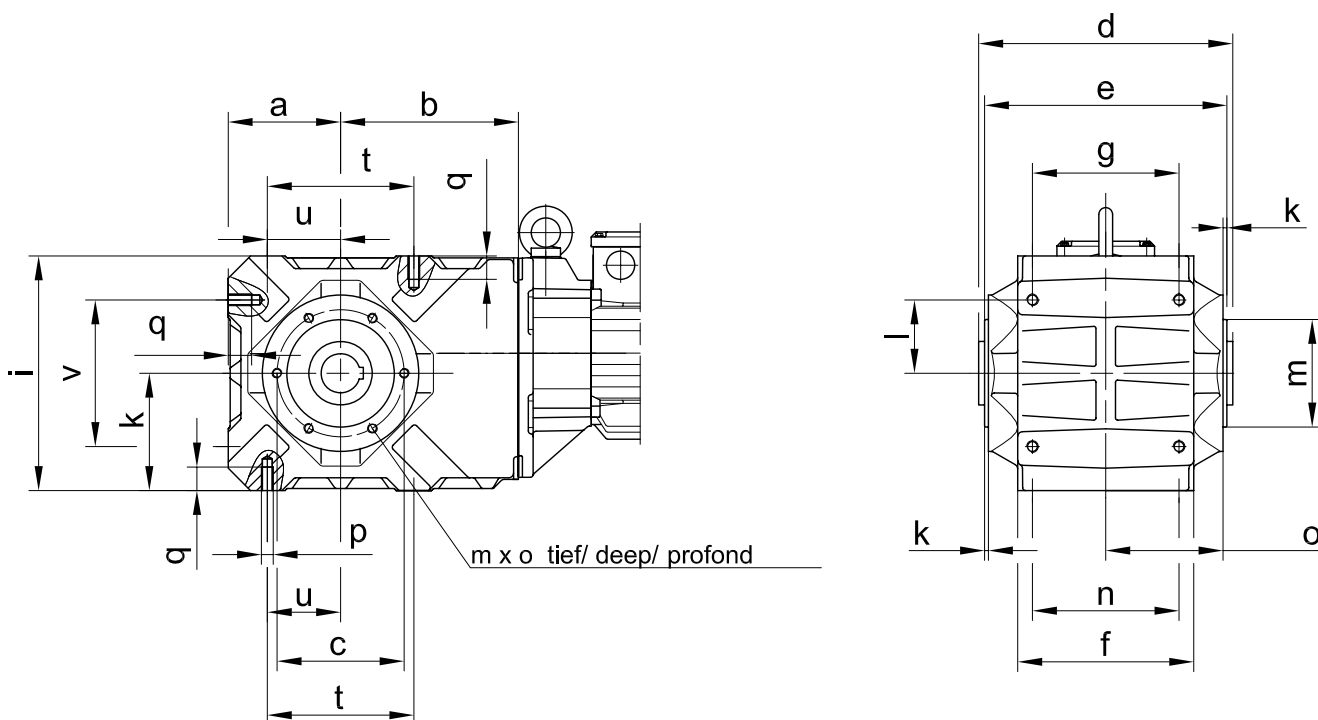

Getriebegrösse Gear size Taille réducteur	a	b	Ø c	d	e	f	g	h	i	k	l	Ø m	n	o	p	q	r	s	t	u	v
BK10	82	124	100	170	161	114	95	3.5	164	80	45	80 <sub>j6</sub>	95	77	M8	16	M8	16	90	45	90
BK20	99	147	115	192	183	128	105	3.5	204	100	55	95 <sub>j6</sub>	105	88	M10	20	M10	20	110	55	110
BK30	109	161	130	224	214	148	120	4	224	110	62.5	110 <sub>j6</sub>	120	103	M12	24	M10	20	125	62.5	125
BK40	120	182	130	260	248	180	150	4	245	120	75	110 <sub>j6</sub>	150	120	M12	24	M10	20	150	75	150
BK50	150	211	165	282	270	190	160	4	305	150	100	130 <sub>j6</sub>	160	131	M14	28	M12	24	200	100	200
BK60	135	197	180	302	288	-	160	4	346	212	85	150 <sub>j6</sub>	-	140	Ø17.5	-	M12	24	180	85	230
BK70	170	230	215	352	338	-	160	4	424	270	100	180 <sub>j6</sub>	-	165	Ø22	-	M16	32	230	110	230
BK80	206	277	265	404	388	-	210	4	524	335	120	230 <sub>j6</sub>	-	190	Ø26	-	M20	40	270	130	360
BK90	251	350	300	484	468	-	210	4	640	410	145	250 <sub>j6</sub>	-	230	Ø33	-	M20	40	330	160	360